

GOVERNMENT OF MEGHALAYA
PUBLIC WORK DEPARTMENT (BUILDING) MEGHALAYA
SHILLONG

NO. PW/CE/BD/98/94/23,
To,

Dt. Shillong, the 18th January/1996.

The Executive Engineer, P.W.D. (Bldg),
Jowai Building Division Jowai.

Sub:-

Construction of Science block cum Auditorium for Kiang Nongbah Govt. College at Jowai (Construction of Science Block only).

1. Part Technical sanction is hereby accorded to the estimate for the above mentioned work amounting to Rs. 53,63,600/- (Rupees Fifty eight lakhs sixty three thousand six hundred) only.
2. The sanction has been registered in this office as PW/CE/Megh/Bldg/10- of 1995-96.
3. The administrative approval to this project has been accorded vide Department letter No. EDN.236/94/6, dt. 31.3.95.
The expenditure on the work is debitable to the head under 4202-Capital outlay on Education, sports Arts & Culture-01-Office Building-203-University & Higher Education-Building-Plan-Sixth Schedule (Part II) Areas-Voted-during 1994-95 and should be met the allotment placed at your disposal from time to time.
4. Arrangements may also be made for the submission of the monthly progress reports on the works in the prescribed form regularly. Also a completion report on the work duly verified by the audit may also be submitted in due course.
6. Please start the work immediately and push through as expeditiously as possible.
7. The sanctioned amount should in no case be exceeded without prior approval from proper authority.
8. The sanctioned estimate is sent herewith along with the necessary drawings for your guidance. Certified copy of the sanctioned estimate and drawings may please be sent to the office.

Encls:- Estimate 2 (two) &
Drawings.

K. D. B. Datta
Chief Engineer, P.W.D. (Bldg),
Meghalaya, Shillong

Office of the Ex. Engineer.

PWD Building Division, Jowai

Copy No. 32 Dt. 24.1.96

Memo No. PW/CE/BD/98/94/23-A, Dt. Shillong, the 7th January, 1996.
Copy for information to :-

1. The Accountant General, Assam, Nagaland & Meghalaya, Shillong.
2. Budget Branch of Secretariat P.W.D. (R&B)
3. Finance 'C' Department Government of Meghalaya, Shillong for information.
4. Secretary P.W.D. (R&B) Meghalaya, Shillong.
5. Budget Branch of Chief Engineer, PWD Building.
6. Planning Department Meghalaya, Shillong for information and necessary action.
7. Finance (FA) Department, Meghalaya, Shillong.
8. Superintending Engineer, P.W.D. (Bldg) Circle for information.

W. D. B. Saha
Chief Engineer, P.W.D.
Meghalaya, Shillong.

Oo

F/s

**APPROVED BUILDING PLAN OF
K.N.B COLLEGE JOWAI SCIENCE BLOCK**

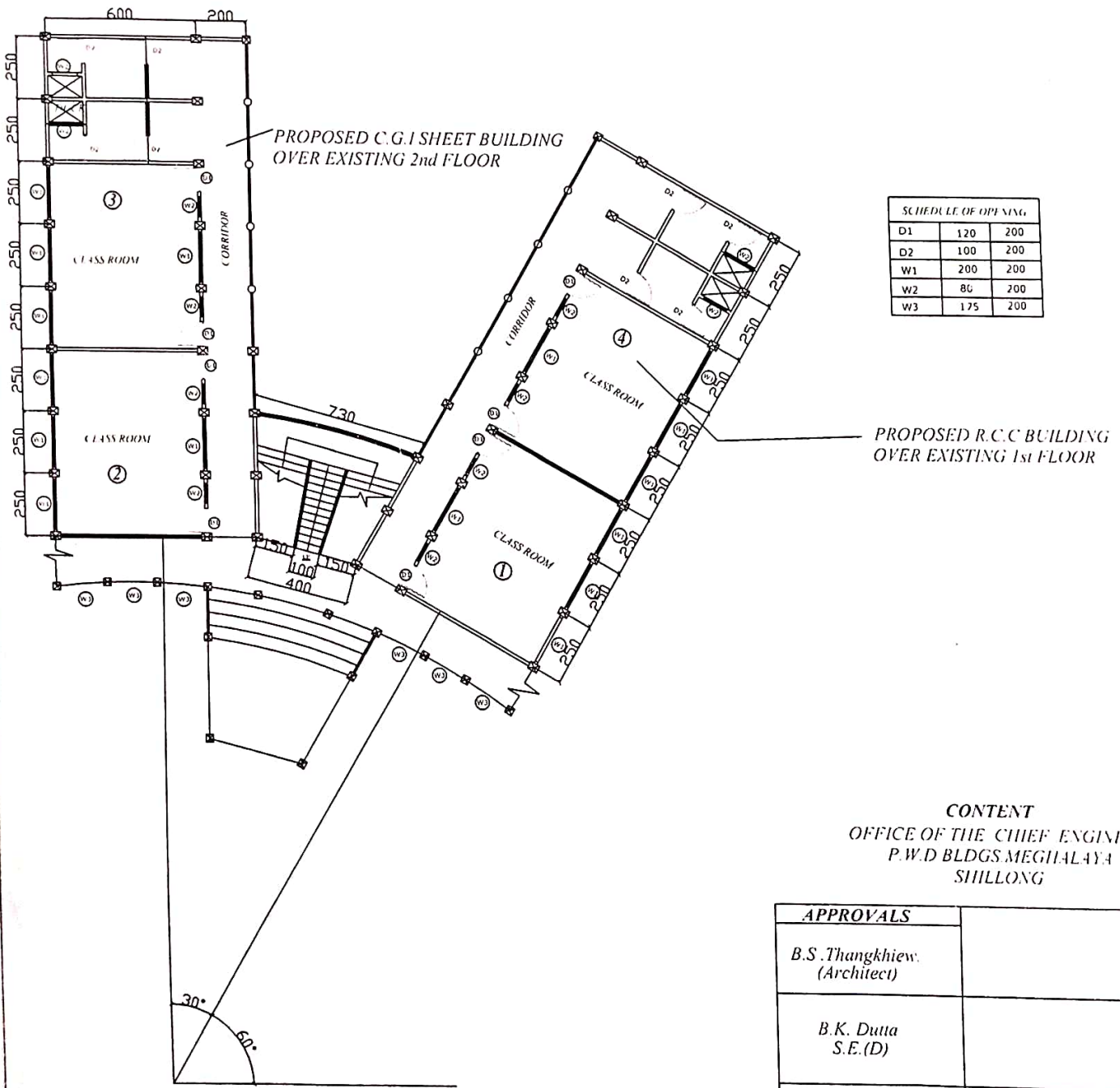

SCHEDULE OF OPENING		
D1	120	200
D2	100	200
W1	200	200
W2	80	200
W3	175	200

CONTENT
OFFICE OF THE CHIEF ENGINEER
P.W.D BLDGS MEGHALAYA
SHILLONG

APPROVALS	
B.S.Thangkhiew. (Architect)	
B.K. Dutta S.E.(D)	
K.D.Bordoloi C.E.(B)	
Dealt & Drawn By T.Passah J.E. P.W.D Bldgs	

CERTIFIED
[Signature]
Executive Engineer, P.W.D.
Jowai Building Division,
Jowai.